

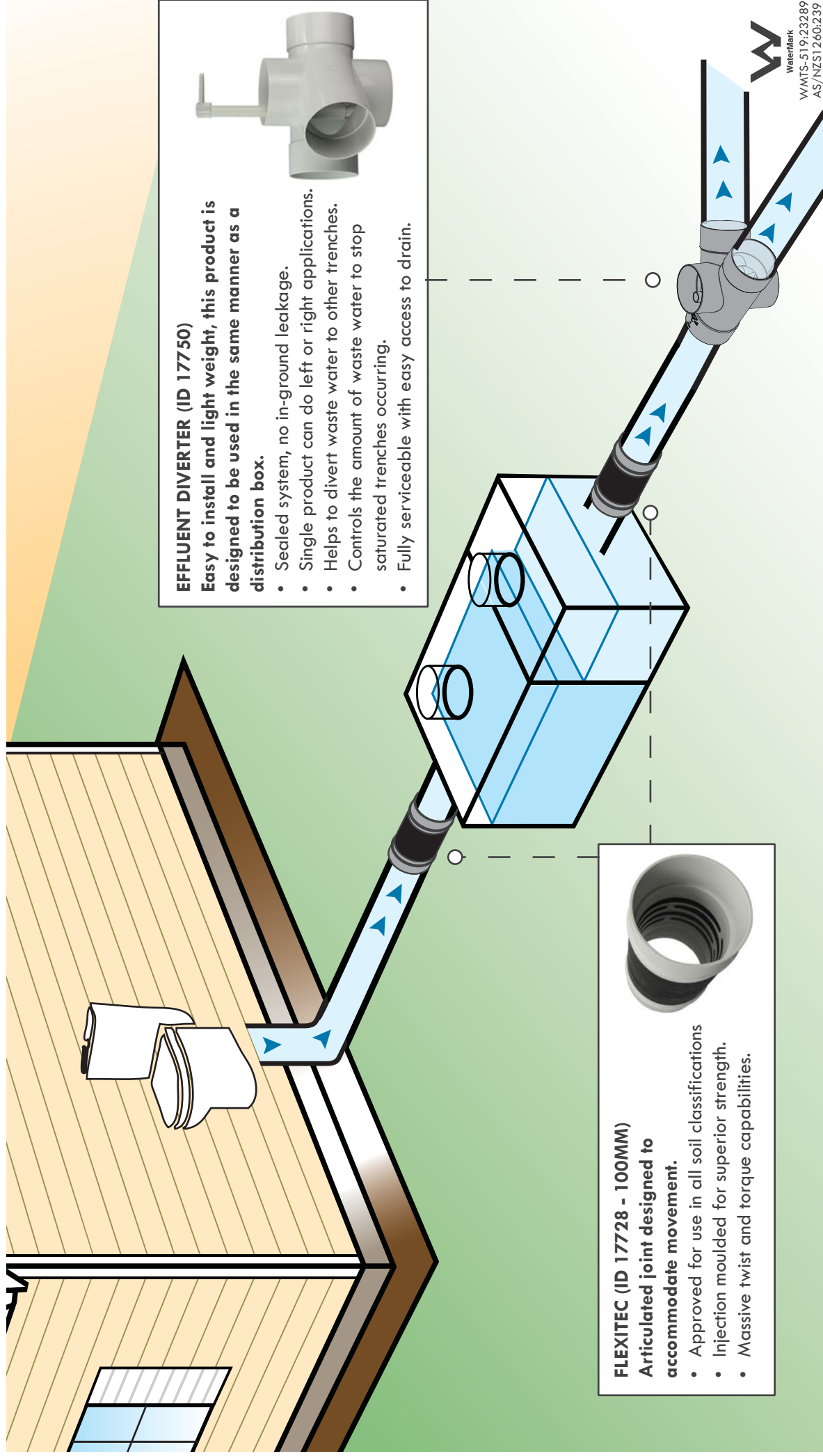

PLASTEC

SEPTIC TANK INSTALLATION

USING PLASTEC'S EFFLUENT DIVERTER



EFFLUENT DIVERTER (ID 17750)

Easy to install and light weight, this product is designed to be used in the same manner as a distribution box.

- Sealed system, no in-ground leakage.
- Single product can do left or right applications.
- Helps to divert waste water to other trenches.
- Controls the amount of waste water to stop saturated trenches occurring.
- Fully serviceable with easy access to drain.



FLEXITEC (ID 17728 - 100MM)

Articulated joint designed to accommodate movement.

- Approved for use in all soil classifications.
- Injection moulded for superior strength.
- Massive twist and torque capabilities.



WaterMark
WMTS-519-23289
AS/NZS1260:239